



MANTONS

ESTATE AGENTS

2 Bedroom Terraced for Sale - £285,000

Wiseman Close, Luton, Bedfordshire, LU2 7GE



KEY FEATURES:

- WELL APPOINTED & PRESENTED TERRACE HOME • TWO GENEROUS SIZE BEDROOMS • NO UPPER CHAIN COMPLICATIONS • DECORATED TO A CONTEMPORARY THEME • IDEAL INVESTMENT, £1250 RENTAL INCOME • FITTED KITCHEN/DINER & MODERN BATHROOM • GAS CENTRAL HEATING VIA COMBI BOILER • WALKING DISTANCE TO OPEN COUNTRYSIDE

Description

MANTONS ESTATE AGENTS are pleased to offer for sale this very well presented two bedroom terrace home located in Bushmead with no upper chain complications.

Decorated throughout to a contemporary with neutral floor coverings, modern bathroom suite & gas central heating serviced via a newly installed combination boiler. This property is an ideal choice for first time buyers or investors (yielding approximately £1250.00 per month in rental income)

In brief the property comprises; Entrance porch, living room with with stairs rising to the first floor, spacious kitchen/diner fitted with gas hob, electric oven, extractor fan & fridge/freezer with patio door opening to the rear garden. Two double bedrooms both with built-in wardrobes & a modern bathroom suite occupy the first floor.

Further benefits include; Double glazed windows & doors, driveway to front, enclosed rear garden with paved patio, rear access & garden shed.

Contact Mantons Estate Agents for further information or to arrange a viewing.

Wiseman Close is a small close located in Bushmead, a very popular housing development constructed in the 1990's. Within walking distance is beautiful open countryside where you can enjoy scenic walks across Warden Hills. Local amenities including; Coop supermarket, chemist, restaurant, hairdressers, doctors & public house. A frequent bus service operates through the development whilst Luton ThamesLink train station is within 2 miles. Luton airport & junction 10 & 11 of the M1 motorway are all within easy reach. Warden Hill Primary & Stopsley/Icknield High are the school catchments.

Additional Information

EPC Rating C. Council Tax Band C. 558 Sq.ft (Approx.)



Ground Floor
Approx. 26.6 sq. metres (286.4 sq. feet)

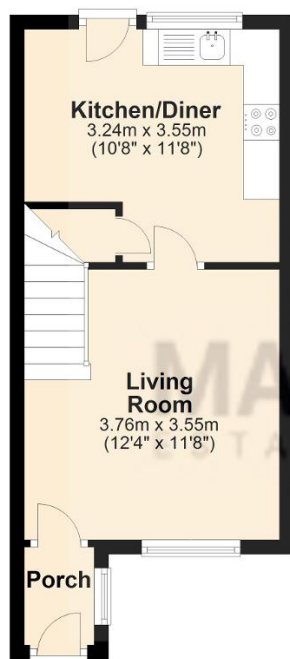

First Floor
Approx. 25.3 sq. metres (272.0 sq. feet)



Total area: approx. 51.9 sq. metres (558.3 sq. feet)