



MANTONS

ESTATE AGENTS

1 Bedroom Park Home for Rent - £750 per month

Westbourne Park, Nursery Road, Luton, Bedfordshire, LU3 2RQ



KEY FEATURES:

- WELL PRESENTED ONE BEDROOM PARK HOME • AVAILABLE TO RENT IMMEDIATELY - £750 • OPEN PLAN KITCHEN/LIVING ROOM • GAS CENTRAL HEATING VIA A COMBI BOILER • RESIDENTS TO BE 45 YEARS OF AGE OR ABOVE • RESIDENT PARKING • MODERN BATHROOM SUITE • WALKING DISTANCE TO LOCAL SHOPS

Description

MANTONS LETTINGS are pleased to offer for rent this well presented one bedroom park home positioned within a short walk of Leagrave ThamesLink train station & Marsh Road where a vast array of local shops can be found.

Decorated to a contemporary theme with modern floor coverings, perfect to move straight into. Open-plan living room/kitchen, modern bathroom & bedroom with fitted wardrobes.

The property is available to rent immediately for £750.00 per month. All residents must be 45 years of age or above with no children or pets.

Further benefits include; Double glazed windows & doors, gas central heating serviced via a combination boiler (LPG), garden shed & resident parking.

Viewings come recommended to fully appreciate the condition & feel this property has to offer.

ADDITIONAL INFORMATION

Council Tax Band A

Available to rent immediately

Deposit £865.00 (5 weeks rent)

Holding deposit £173.00 (1 weeks rent)

Part furnished - Kitchen appliances & wardrobes

Client Money Protect Scheme (CMP) member number CMP005252

The Property Ombudsman (TPO) member number D12281

Westbourne Park is located in Leagrave within a short walk of Leagrave ThamesLink train station and Marsh Road where you will find a vast array of supermarkets, food outlets & convenience stores. Easy access to Junction 11 of the M1 motorway & Luton & Dunstable hospital.



Ground Floor

Approx. 33.2 sq. metres (357.9 sq. feet)

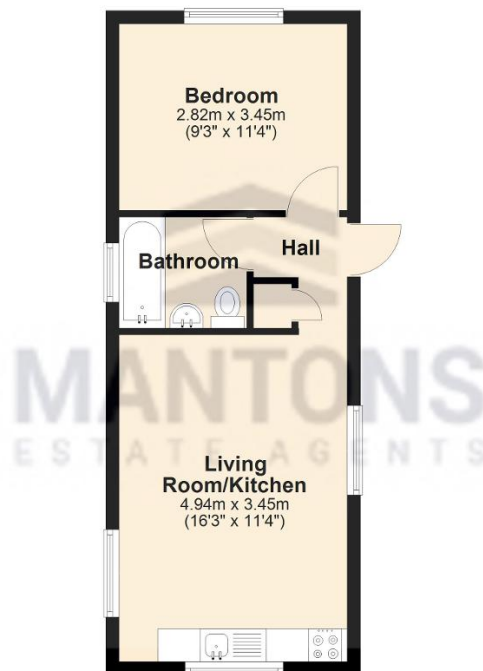

Total area: approx. 33.2 sq. metres (357.9 sq. feet)