



MANTONS

ESTATE AGENTS

3 Bedroom Terraced for Sale - £310,000

Onslow Road, Luton, Bedfordshire, LU4 9AJ



KEY FEATURES:

- WELL APPOINTED TERRACE HOME • THREE WELL PROPORTIONED BEDROOMS • NO UPPER CHAIN COMPLICATIONS • MODERN BATHROOM SUITE • 13FT LIVING ROOM & FITTED KITCHEN/DINER • WALKING DISTANCE TO LEAGRAVE STATION • EASY ACCESS TO M1 JUNCTION 11 & 11A • WALKING DISTANCE TO AN ARRAY OF SHOPS

Description

MANTONS ESTATE AGENTS are delighted to present this well appointed, three bedroom terrace home, available for sale with no upper chain complications.

This property boasts several attractive features, including a double width driveway, solar panels & fitted kitchen/diner with French doors leading to a private rear garden.

The property layout is as follows: an entrance hall with stairs leading to the first floor, 13ft living room that flows into a fitted kitchen/diner both with wood flooring (installed 1 year ago). Upstairs, you will find three generously sized bedrooms (bedroom 1 & 3 with air conditioning units) & a modern bathroom suite.

Additional benefits include double glazed windows & doors, gas central heating (boiler serviced annually), ladder access to the loft, enclosed rear garden with patio area & garden shed to remain.

For more information or to arrange a viewing, please contact Mantons Estate Agents.

Onlsow Road lies in the heart of Legrave, just a brief stroll from Legrave ThamesLink train station & Marsh Road, where a plethora of supermarkets, eateries & convenience stores await. With seamless access to Junctions 11 & 11a of the M1 motorway & proximity to the Luton & Dunstable Hospital, convenience is at your doorstep. Additionally, it falls within the catchment areas of Legrave Primary & Lealands High School, making it an ideal location for families.

Additional Information

EPC Rating - C. Council Tax Band - B. 782 Sq.ft (Approx).



Ground Floor

Approx. 34.8 sq. metres (375.0 sq. feet)

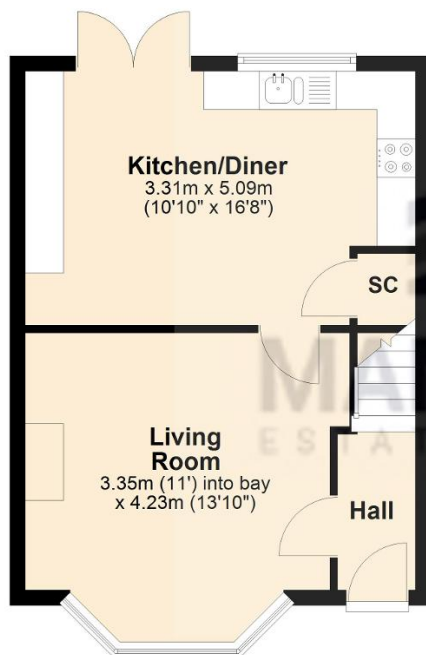

First Floor

Approx. 37.8 sq. metres (407.0 sq. feet)

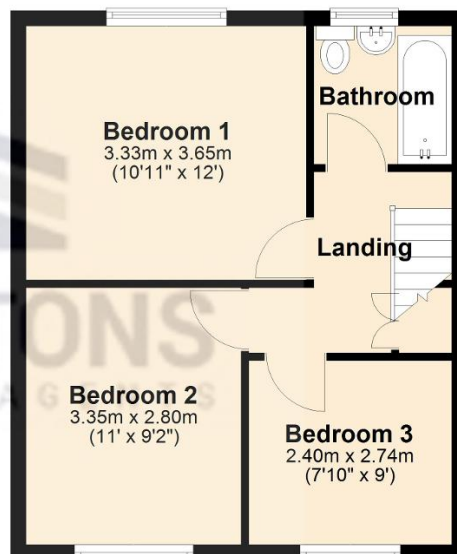

Total area: approx. 72.7 sq. metres (782.1 sq. feet)