



MANTONS

ESTATE AGENTS

1 Bedroom Flat for Sale - £135,000

Handcross Road, Luton, Bedfordshire, LU2 8JJ



KEY FEATURES:

- VERY IMPRESSIVE SECOND FLOOR APARTMENT • NO UPPER CHAIN COMPLICATIONS • IDEAL FIRST TIME OR INVESTMENT PURCHASE • ONE DOUBLE BEDROOM • 999 YEAR LEASE FROM 1975 • ALLOCATED PARKING BAY & GARAGE IN BLOCK • FITTED KITCHEN & BATHROOM • EASY ACCESS TO M1 JUNCTION 10 & AIRPORT

Description

Mantons Estate Agents proudly presents this exceptional one-bedroom second-floor apartment situated in the highly sought-after Stopsley area, boasting no upper chain complications.

Perfect for first-time buyers or investors, with potential rental income of £800 per month. 950 years remaining on the lease & £70.00 per month which covers the service charge, ground rent & Building insurance.

The property features a communal entrance with secure intercom system, entrance hall, spacious living room, double bedroom, well-appointed fitted kitchen, and bathroom suite.

Additional advantages include double glazed windows, allocated parking bay, and garage within a block.

Contact Mantons Estate Agents today to schedule a viewing or for more details.

Located in the highly desirable Stopsley area, Dellfield Court was built in the 1970s, offering convenient access to key amenities & transport links. London Luton Airport, Junction 10 of the M1 motorway, and Luton Parkway ThamesLink train station are all easily reachable, ensuring seamless connectivity for travelers & commuters alike. Additionally, the nearby 'Asda' supermarket is just a short drive away, while the 'Someries' Primary school & 'Putteridge' High school are both within walking distance, providing families with convenient access to quality education options.

Additional Information

EPC Rating D. Council Tax Band A. 328 sqft (Approx.).

LEASE INFORMATION

Lease - 950 years remaining approximately (999 year lease from 1975).

Service charge, Ground rent & Building insurance - £70 per month (approx)



Second Floor

Approx. 30.5 sq. metres (328.1 sq. feet)

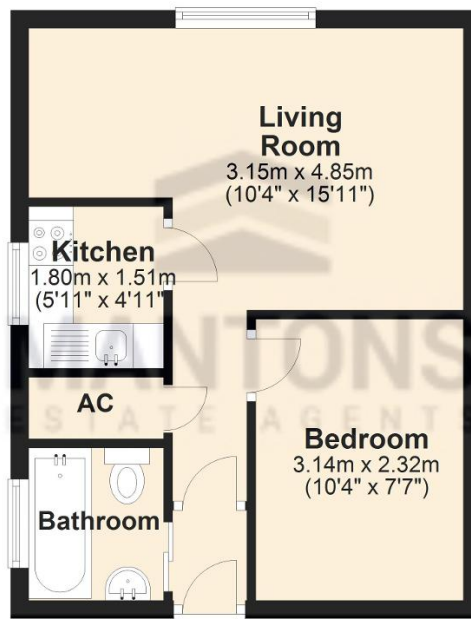

Total area: approx. 30.5 sq. metres (328.1 sq. feet)