



MANTONS

ESTATE AGENTS

1 Bedroom Park Home for Rent - £735 per month

Nursery Road, Luton, Bedfordshire, LU3 2RQ



KEY FEATURES:

- WELL PRESENTED ONE BEDROOM PARK HOME • AVAILABLE TO RENT IMMEDIATELY - £735 •
- DECORATED TO A CONTEMPORARY THEME • GAS CENTRAL HEATING VIA A COMBI BOILER • RESIDENTS TO BE 45 YEARS OF AGE OR ABOVE • MODERN KITCHEN & SHOWER ROOM • NEWLY LAID FLOOR COVERINGS • DOUBLE GLAZED WINDOWS & DOORS

Description

MANTONS LETTINGS are pleased to offer for rent this very impressive one bedroom park home positioned within a short walk of Legrave Thames Link train station & Marsh Road where a vast array of local shops can be found.

The property has recently been decorated with new floor coverings, perfect to move straight into.

The property is available to rent immediately for £735 per month which includes water rates. All residents must be 45 years of age or above with no children or pets.

In brief the property comprises; Entrance hall, double bedroom, modern shower room, fitted kitchen opening to the living room.

Further benefits include; Double glazed windows & doors, gas central heating serviced via a combination boiler (LPG), garden shed & resident parking .

Viewings come recommended to fully appreciate the condition & feel this property has to offer.

ADDITIONAL INFORMATION

Council Tax Band A

Available to rent immediately

Deposit £845.00 (5 weeks rent)

Holding deposit £169.00 (1 weeks rent)

Unfurnished

Client Money Protect Scheme (CMP) member number CMP005252

The Property Ombudsman (TPO) member number D12281

Westbourne Park is located in Legrave within a short walk of Legrave Thames Link train station and Marsh Road where you will find a vast array of supermarkets, food outlets & convenience stores. Easy access to Junction 11 & 11a of the M1 motorway & Luton & Dunstable hospital.



Ground Floor

Approx. 32.8 sq. metres (352.9 sq. feet)

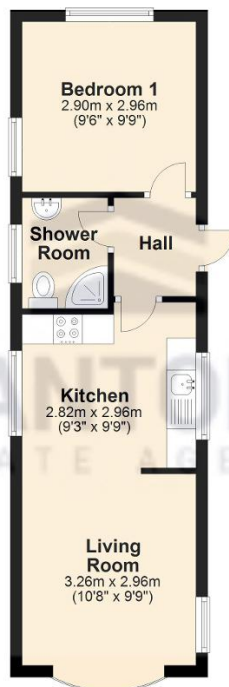

Total area: approx. 32.8 sq. metres (352.9 sq. feet)